



# 7854T

## USER MANUAL



Made in Italy

AVS: Rev 08/16

|        |  |
|--------|--|
| 2..... | Table of contents  |
| 3..... | Introduction   |
| 4..... | Alarm control devices                                      |
| 4..... | Remote control   |
| 4..... | Electronic key   |
| 5..... | Alarm operation  |
| 5..... | Arming   |
| 5..... | Passive arming   |
| 5..... | Topcase/Seat open warning signal                           |
| 5..... | Pre-arm mode   |
| 5..... | Siren exclusion  |
| 6..... | Motion sensor exclusion                                    |
| 6..... | Full arming  |
| 6..... | Alarm  |
| 6..... | Limiting acoustic signals                                  |
| 6..... | Neutral time between alarms                                |
| 7..... | System disarming without alarm memory                      |
| 7..... | System disarming with alarm memory                         |
| 7..... | Hazard feature   |
| 8..... | Programmable features                                      |
| 8..... | Acoustic signals   |
| 8..... | Panic siren  |
| 8..... | Sleep mode Activation/Deactivation                         |
| 8..... | Use and maintenance  |
| 9..... | Replacing remote control batteries                         |
| 9..... | Waste electrical and electronic equipment (WEEE) directive |

# INTRODUCTION

**Dear Customer,**

Thank you for choosing a Gemini product. This Thatcham approved 7854T alarm system has been designed and manufactured in Italy specifically for two-wheeled vehicles.

Please read the present manual carefully to familiarize yourself fully with the alarm system features and operating procedures and do keep it handy for future reference.

The following signal words are used throughout this manual to emphasize important instructions or special information.

## **⚠ WARNING**

Non-compliance to this instruction will result in serious damage to the alarm system and the vehicle itself.

## **CAUTION**

Non-compliance to this instruction may cause serious damage or operational failures to the alarm system.

## **NOTE**

Provides useful information.

# ALARM CONTROL DEVICES

The 2-button remote control and the electronic key are used to operate the alarm system.

## Remote control

The remote control has 2 different function buttons each of which corresponds to a control signal that activates a selected action according to the operational condition and alarm configuration.

The textured button is for arming/disarming the alarm while the smooth button is used to exclude or trigger the siren.

The remote control has a low charge battery indicator that gives you early warning to avoid malfunctioning. When the batteries are fully charged, the LED will show a steady light at the press of a button. If the batteries are too weak for normal operation, the LED will start blinking at the press of a button.

- Button 1: ● Alarm arming/disarming  
● Panic siren activation/deactivation
- Button 2: ● Siren ON/OFF during an alarm condition  
● Siren ON/OFF when arming  
● Hazard feature activation

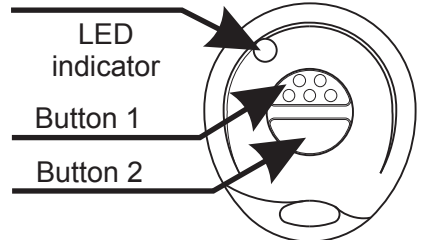

## Electronic key

The electronic key is a simplified remote control. In emergency situations (ex. in case of remote control failure), it can be used to arm/disarm the alarm or activate/deactivate the panic siren (if previously enabled).

To use the electronic key, simply touch it to its receptacle. The receptacle incorporates a LED warning light that serves as both a system status indicator and a visual theft deterrent.

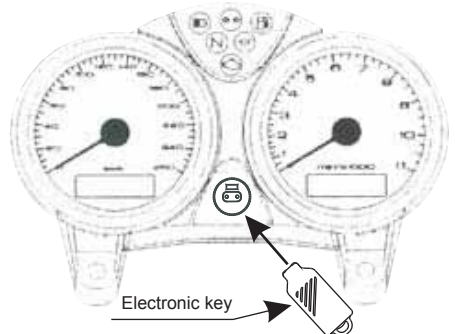
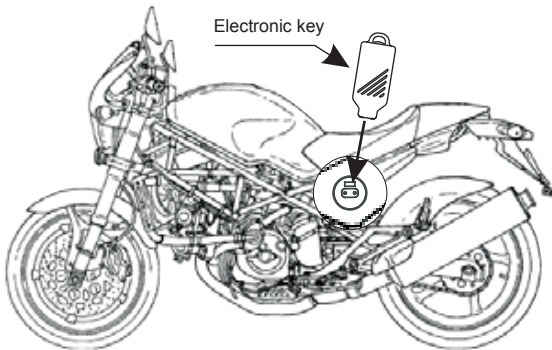

# ALARM OPERATION

## *Arming*

Press remote control button 1 or insert the electronic key into its receptacle to arm the alarm. Arming is confirmed by a long flash of the turn indicators and 2 short beeps. The LED turns ON steady.

## *Passive arming*

Passive engine immobiliser arms automatically 40" after ignition is turned-off. Lifting the seat or opening the topcase (if protected by a contact switch) during the 40" pre-arming time will cause the procedure to interrupt; it will resume once the seat or the topcase are closed. Passive arming is confirmed by 2 beeps and 2 flashes of the turn indicators and the LED will start flashing quickly. To disarm passive engine immobiliser, turn ignition ON and press any remote control button.

## *Topcase/Seat open warning signal*

If, during the arming process, the seat or topcase are open or incorrectly closed, a low-tone beep (BOOP) will sound after the arming confirmation tones. The alarm will arm but an alarm condition will be triggered after the pre-arm mode.

## *Pre-arm mode*

After the arming confirmation signals, the LED turns ON steady to indicate the system is in pre-arm mode; it will become fully active after 20". Engine immobilization and optional module inputs are already active.

## *Siren exclusion*

During the first 4 seconds of the pre-arm mode, the alarm siren can be excluded by pressing remote control button 2. The turn indicators will flash to confirm the siren has been excluded.

## **NOTE**

If the siren is excluded (Mute Alarm) only the turn indicators will flash during an alarm condition. Engine immobilization remains enabled.

**NB:** Siren exclusion is bound to each single arming cycle.

### ***Motion sensor exclusion***

The alarm built-in sensor to detect tilt, motion or a sudden shock can be excluded during the first 4" of the pre-arm time by inserting the electronic key into its receptacle after the alarm system is fully armed. The status LED will blink once to confirm the sensor has been excluded.

**NB:** Tilt sensor exclusion is bound to each single arming cycle.

### ***Full Arming***

After the 20" pre-arm time, the alarm is fully armed and ready to detect any irregularity. The LED will start blinking to confirm the armed condition.

### ***Alarm***

If an alarm condition is detected during the armed state, the siren will sound, the red LED will turn ON steady and the turn indicators will flash repeatedly for approx. 30 seconds.

The following irregularities will trigger the alarm if the relative sensors are activated:

- Cable cut tamper detection;
- Ignition attempt;
- Motion detection (ex. lifting, towing, forcing the steering lock);
- Seat/topcase unauthorized access;
- Panic siren (button 2).

When the alarm condition ceases, the system returns to the armed mode.

To interrupt the siren during an alarm condition, without disarming the alarm, press button 2 .

### ***Limiting acoustic signals***

Alarm conditions caused by unauthorized movement or seat/topcase opening, will trigger a maximum of 8 consecutive alarm cycles. The siren will then be automatically excluded for the following reasons:

- To comply with the regulations in force aimed at limiting noise pollution;
- To save power and maximize vehicle battery life;
- If, after 8 times, no one checks the vehicle, it is useless to have it sound again.

### ***Neutral time between alarms events***

When the alarm cycle is over, any further alarm condition will be ignored for 8 seconds; the LED will be ON steady. After this time interval, the system will return to its previous state confirmed by the blinking LED.

### ***System disarming without alarm memory***

Press remote control button 1 or insert the electronic key in its receptacle to disarm the alarm. Disarming will be confirmed by 3 beeps and 3 flashes of the turn indicators and the LED will turn OFF.

### ***System disarming with alarm memory***

If an alarm condition has occurred while you were away from your vehicle, it will be signaled by 2 low tone beeps and 2 flashes of the turn indicators when disarming the system.

The last cause of alarm can be identified by observing the status LED:

- **Ignition attempt alarm:** 2 flashes of the turn indicators, 2 LED flashes and 2 low tone beeps.
- **Topcase/seat alarm:** 3 flashes of the turn indicators, 3 LED flashes and 3 low tone beeps.
- **Cable cut alarm:** 4 flashes of the turn indicators, 4 LED flashes and 4 low tone beeps.
- **Motion alarm:** 5 flashes of the turn indicators, 5 LED flashes and 5 low tone beeps.
- **Wireless magnetic contacts or opening detectors:** 8 flashes of the turn indicators, 8 LED flashes and 8 low tone beeps.
- **Wireless infrared sensors (PIR) or wireless hyper-frequency sensors:** 9 flashes of the turn indicators, 9 LED flashes and 9 low tone beeps.

### ***Hazard feature***

To make the turn indicators flash as hazard warning lights proceed as follows:

- Turn ignition key “OFF”.
- Then turn it “ON”; the LED will light up for approx. 1”.
- While the LED is ON, press remote control button 2.
- Turn ignition key “OFF”; the turn indicators will start flashing.
- To deactivate, turn ignition key “ON” (and eventually “OFF”) or arm and disarm the system via the remote control or the electronic key.

## PROGRAMMABLE FEATURES

The alarm is factory preset with the following features enabled:

| <i>Factory settings</i> |              |
|-------------------------|--------------|
| <i>Feature</i>          | <i>State</i> |
| Acoustic signals        | Enabled      |
| Panic siren             | Enabled      |

- **Acoustic signals:** to indicate arming/disarming, alarm memory, function programming and learning of new devices.
- **Panic siren:** for use in emergency situations. Panic alarms can be triggered as many times as necessary, but at least 5" must elapse between 2 consecutive alarms. Pressing button 2 will immediately activate the siren and the turn indicators for approx. 30 seconds.  
To deactivate the panic alarm, simply press button 2 again.

## SLEEP MODE ACTIVATION/DEACTIVATION

If the vehicle will be sitting idle for long periods of time, the alarm can be switched off (sleep mode) to preserve battery life.

To activate Sleep Mode, proceed as follows:

- Turn ignition key "ON"; the LED will light up for approx. 1 second.
- Insert the electronic key into its receptacle within 4 seconds.
- A beep will confirm the alarm has been turned off.
- Turn ignition key "OFF".
- To return the system to full operation mode, turn ignition key "ON" and then "OFF".

## USE AND MAINTENANCE

Care should be taken to protect the electronic alarm system:

- Do not clean the alarm with water but use a damp cloth to wipe.
- Do not expose the alarm to heat sources.
- Do not use voltages other than the one specified by the manufacturer.
- Protect the alarm from any direct water flow, such as a high-powered water jet found in a car wash.

### **WARNING**

GEMINI TECHNOLOGIES S.p.A. WILL NOT BE HELD RESPONSIBLE FOR ANY DAMAGE CAUSED BY IMPROPER USE.



## REPLACING REMOTE CONTROL BATTERIES

The remote control operates with alkaline batteries. When the batteries are too weak, replace them as follows:

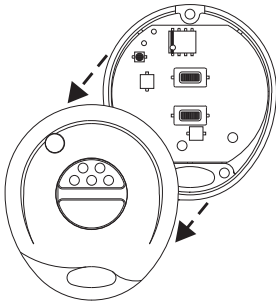

Separate the shell halves taking care not to damage the internal circuit.

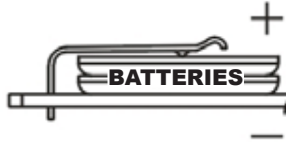

Remove the discharged batteries and insert the new ones taking care not to invert the polarity.

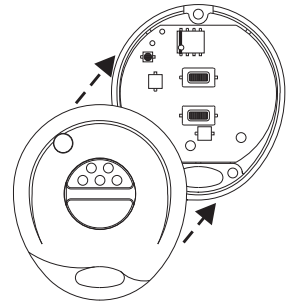

Close the plastic shells and make sure the remote works properly.



Use only CR1616 batteries.  
Different type batteries can seriously damage the remote control unit. Discard used batteries properly in special dedicated containers.

## WASTE ELECTRICAL AND ELECTRONIC EQUIPMENT (WEEE) DIRECTIVE

The present device does not fall within the scope of Directive 2002/96/EC on Waste Electrical and Electronic Equipment (WEEE) as specified in art. 2.1 of L.D. no. 151 of 25/07/2005.



## **Aftermarket Vehicle Solutions Limited**

7 Dudley Court , Jessop Close, Clacton-on-Sea, Essex, CO15 4LY

TEL: +44 (0) 1255 434353

Email: [sales@avsgemini.com](mailto:sales@avsgemini.com) | Web: [www.avsgemini.com](http://www.avsgemini.com)

UK Distributors of the Gemini Alarm Systems

AVS reserve the right to effect changes to the product without further notice. E&OE

### **GEMINI Technologies S.p.A.**

Via Luigi Galvani 12 - 21020 Bodio Lomnago (VA) - Italia

Tel. +39 0332 943211 - Fax +39 0332 948080

[www.gemini-alarm.com](http://www.gemini-alarm.com)

ISO 90001 Certified Company



Reg. n. 532-A  
UNI EN ISO 9001:2008